

# Access Statement

## Moor Croft, Back St Hilda's Terrace, Whitby

Arrival: The majority of guests arrive at the cottage by car. There is a private parking space immediately to the rear of the cottage with step-free access. For loading and unloading the car lies within 15 metres of the front door.

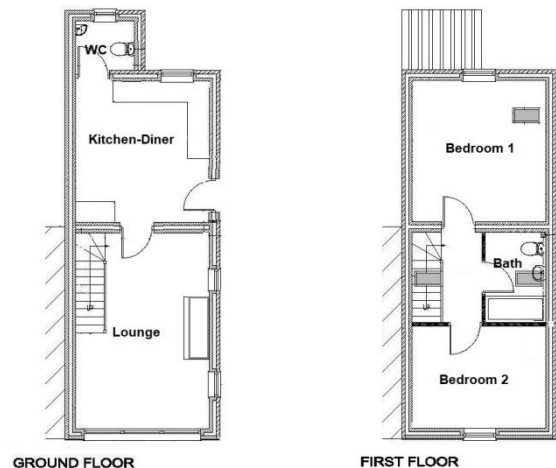

There are train, bus and taxi services to Whitby and a taxi from the station to the house is usually less than £5. The nearest bus stop is about 50m away on Upgang Lane. The nearest train station is in the town centre about 500m away.

Entrance: The front door threshold is just a few inches (c.10cm) above the level of the entrance path which is level with the parking space and outdoor patio seating area.

Inside, clear door widths in the cottage are all at least 68cm (and most are excess of 73cm) wide. There is a downstairs cloakroom with a toilet and washbasin that can be accessed from the dining kitchen and lounge step-free. There are tiles on the kitchen and cloakroom floors, with vinyl flooring in the bathroom and carpets throughout the remainder of the cottage.

The bedrooms and the bathroom are upstairs. The stairs are approx. 75 cm wide, comprising 13 steps with a turn at the top onto the galleried landing. The risers are approx. 19cm high and the treads are 25cm wide.

The property has easy to reach power sockets in all of habited rooms, save for the bathroom. The property has no phone, but there is broadband and mobile phone coverage for most networks.

The parking space is approx.. 4.6m x 2.4m (15'x 8')

### Mobility Equipment Hire

Wheelchairs and mobility scooters etc can be hired locally from:

Whitby DAG, Church House Centre, Flowergate, Whitby YO21 3BA

Tel: 01947 821001      [www.whitbydag.org.uk](http://www.whitbydag.org.uk)

James & Kate Smith

March 2019